

Double Arm Flat Screen Desk Mount

 For more information please visit www.btechavmounts.com/BT7373

BT7373

BT7373

Double Arm Flat Screen Desk Mount

**Designed for screens up to 24"
(61cm) / 9kg (20lbs)**

- Fits screens with VESA mounting patterns: 75 x 75mm and 100 x 100mm
- Supplied with both a desk clamp and grommet
- Maximum extension: 457mm
- Easy tilt adjustment: +/-40°
- Features three swivel points: 360° at pole, 360° at pivot and 180° at interface
- Integrated cable management
- Easy height adjustment using tool-less locking ring
- Simple installation with all fixings included
- Available in a stylish Graphite Black



Supplied with a desk clamp to attach the mount to the rear or side of a desk up to 70mm thick



The fully adjustable head is ideal for easy positioning of the screen



Also included is a grommet to attach the mount through a desk of up to 95mm thick



Cable management is integrated into the mount for a clean and tidy installation

Double Arm Flat Screen Desk Mount

For more information please visit www.btechavmounts.com/BT7373

BT7373

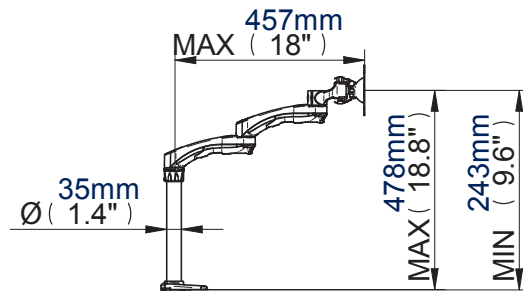

Side View

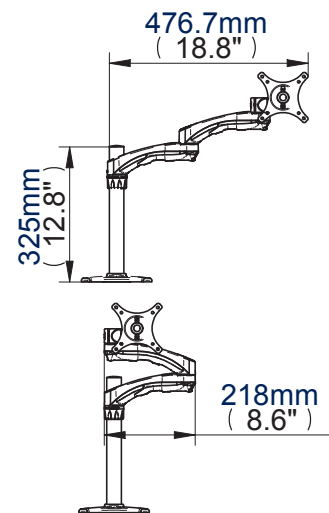

Front View

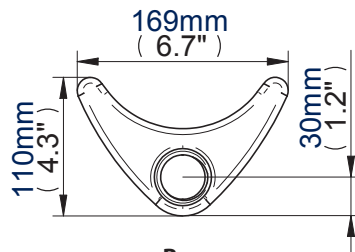

Base

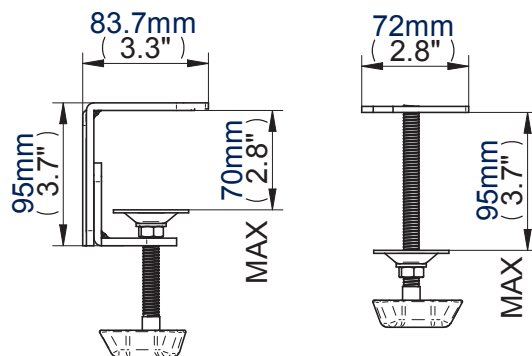

Grommet

Desk Clamp

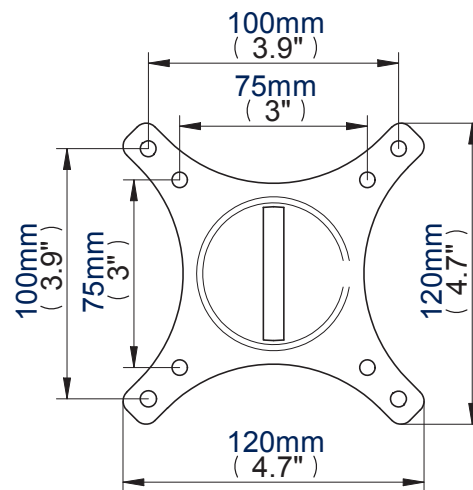

Interface Plate

Colour:	Order Ref:	EAN Code:	Master Carton Qty:	Inner Carton Qty:	Master Carton Weight:	Master Carton Cube:
Graphite Black	BT7373/GB	5019318752179	2	0	7.75kg (17.05lbs)	0.047cbm (1.67cuft)

This information is intended as a guide only and reflects the current specification at the time of print.
B-Tech accepts no liability for the accuracy of the information contained in this document.